

## Models-1011, 1012, 1013, 1014. Aluminium Case & Brass Internals

### *Case*

Aluminium Stove Enamelled Finish.  
Solid front between bourdon tube and dial.

### *Bezel*

Brass with Chrome Finish

### *Socket*

Brass  
Stainless Steel

### *Element*

*Bourdon Tube*  
Beryllium copper  
Phosphor Bronze  
Stainless Steel

### *Thread*

1/8", 1/4", 3/8", 1/2" NPT, BSP, BSPT

### *Movement*

Brass / Stainless Steel

### *Dial*

White Aluminium (Black Printing)

### *Pointer*

Black Aluminium

### *Window*

Laminated Safety Glass

### *Standard Size*

63, 100, 150mm

### *Accuracy class*

1%

### *Scale Range*

Vacuum to 1,000 bar (14,500 psi)

### *Ordering information*

State:- Pressure gauge model  
/Nominal size / Scale range  
/ Size and location of connection / Optional extras reqd.



Model - 1012

### *Optional extras*

200 & 250mm dia gauges.  
White plastic dial (Black Printing).  
Micro adjustable pointer / Black Finish.  
Other pressure connections.  
Monel to Nace MR-01-75,  
Perspex window.  
Customer logo.  
Vibragauge®  
Snubbagauge®  
**Further options: on request**

We manufacture a wide range of instruments to customer's special requirements  
We shall be pleased to discuss and advise on your specifications.

Specifications and dimensions given in this leaflet represent the state of engineering at the time of printing.  
Engineering modifications may take place without prior notice.

## Models-1011, 1012, 1013, 1014. Aluminium Case & Brass Internals

Surface Mounted  
Model - 1011

Direct Mounted  
(Standard)  
Model - 1012

Flush Mounted  
Screw Fixing  
Model - 1013

Flush Mounted  
Clamp Fixing  
Model - 1014

Bottom connect

Rear connect

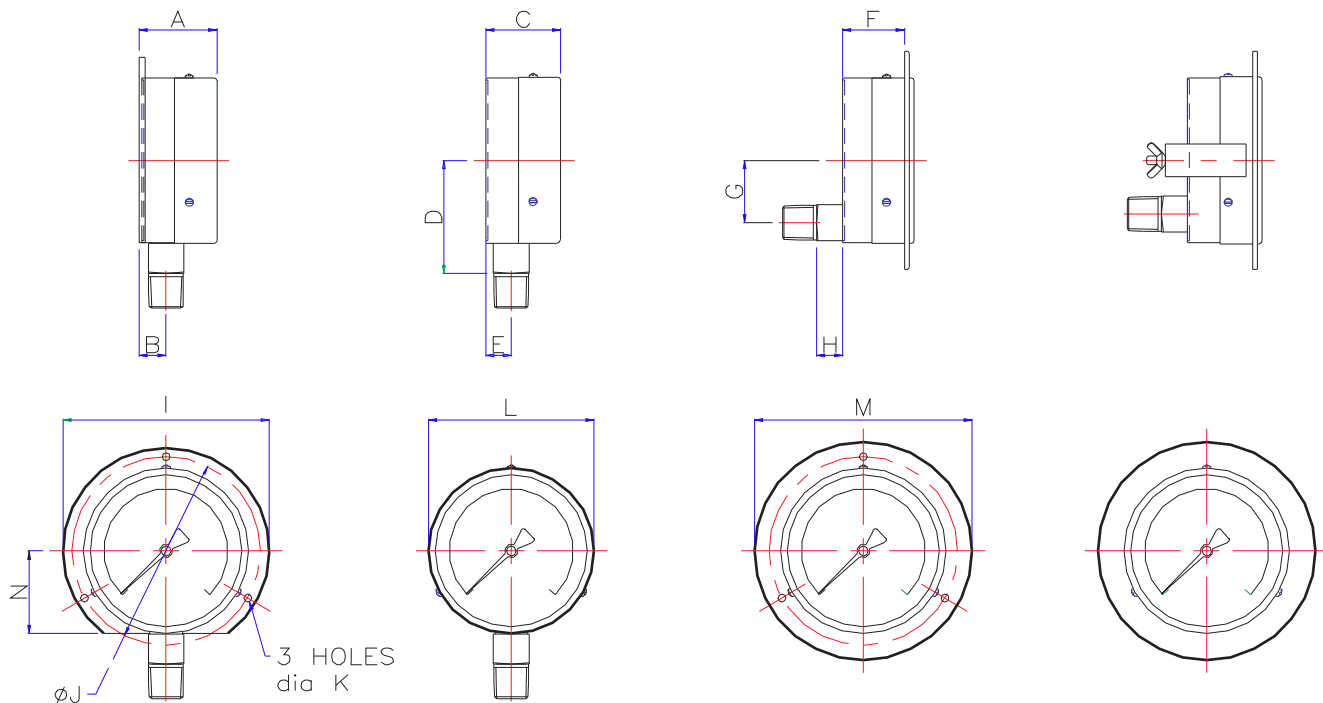

Dimensions Diameter	A	B	C	D	E	F	G	H	I	J	K	L	M	N	Panel Cut-out
63	35	11	35	38.5	11	29	21	6	86	75	3.6	65	90	32	70
100	49	18	45	70	17.5	49	32	13	130	118	6	103	135	51	106
150	53	17.5	50	92	18	50	32	13	183	168	6	153	185	75.5	155

Gas and Steam in excess of 25 Bar pressure can represent danger if there is a rupture in the Bourdon Tube measuring this gas. To minimize the danger, gauges in this application should be Safety Pattern type, having solid front between Bourdon tube and dial, safety window and blow-out back to allow any blast to release to the rear of gauge.  
Although there is not necessarily any great risk in the use of gauges for gases at pressure less than 25 Bar, a blow-out disc should be incorporated and the purchaser should have regard to the nature of the gas and the installation conditions and, if necessary, order a gauge of the Safety Pattern type.  
Surface mounted gauges should be fitted with distance pieces of not less than 3/4" (20mm) long to allow them to be mounted away from wall or panel.